



Pharma Hygiene Products offer a wide range of standard storage, mixing and transport vessels, from small bowls up to larger 200 litre tanks.

Mixing and storage containers

Manufactured from 316L and 304 grade stainless steel, these containers can be supplied either plain or graduated and come complete with side handles and skirtband. They have crevice- and pit-free interiors and are polished throughout. An optional lid is available for all sizes, and most can be integrated with a mixer.

Please also see our **Customised Process Equipment** section on page 15 for more bespoke solutions.

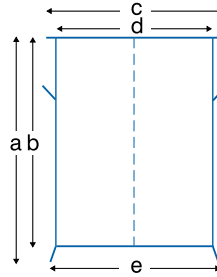

Item code	Capacity (litres)	a	b	c	d	e	Skirt	Handle	Grad.	Weight (kg)	Lid code	Lid weight (kg)
VES4020P	20	390	380	350	265	275	YES	SIDE	-	3.4	VEL4020P	0.6
VES*020G	20	390	380	350	265	275	YES	SIDE	5-20/5	3.4	VEL*020P	0.6
VES4025P	25	390	380	380	300	305	YES	SIDE	-	3.8	VEL4025P	0.8
VES*025G	25	390	380	380	300	305	YES	SIDE	5-25/5	3.8	VEL*025P	0.8
VES4030P	30	460	445	380	300	305	YES	SIDE	-	4.4	VEL4030P	0.8
VES*030G	30	460	445	380	300	305	YES	SIDE	5-30/5	4.4	VEL*030P	0.8
VES4050P	50	560	535	435	350	355	YES	SIDE	-	6.4	VEL4050P	1
VES*050G	50	560	535	435	350	355	YES	SIDE	5-50/5	6.4	VEL*050P	1
VES4075P	75	625	600	480	400	405	YES	SIDE	-	8.5	VEL4075P	1.3
VES*075G	75	625	600	480	400	405	YES	SIDE	5-75/5	8.5	VEL*075P	1.3
VES4100P	100	675	650	520	445	455	YES	SIDE	-	12	VEL4100P	1.6
VES*100G	100	675	650	520	445	455	YES	SIDE	10-100/10	12	VEL*100P	1.6
VES4150P	150	675	650	620	550	555	YES	SIDE	-	16	VEL4150P	2.3
VES*150G	150	675	650	620	550	555	YES	SIDE	10-150/10	16	VEL*150P	2.3
VES6240P	240	890	850	730	600	625	YES	SIDE	-	26	VEL6240S	3

- Notes:**
1. Graduations: 5-20/5 = graduated from 5 litres to 20 litres in 5 litre intervals.
 2. In the data table, replace the * with 4 if 304 grade is required, or with 6 if 316L grade is required.
 3. Where no * occurs in the item code, material is 304 grade.

Options: (see key to symbols on pp 19-20)

Mobile frames

Manufactured from 304 grade stainless steel, these mobile frames are ideal for moving our mixing and storage vessels smoothly and safely, without lifting or carrying. Supplied with four castors, two with brakes, they are available with straight or angled locating flanges.



Item code	Suit vessel capacity (litres)
FRA4020*	20
FRA4025*	25
FRA4030*	30
FRA4050*	50
FRA4075*	75
FRA4100*	100
FRA4150*	150
FRA4200*	200



Cans with lids

Manufactured from either 304 or 316L grade stainless steel, these cans come complete with lids and swing handles. They have crevice- and pit-free interiors and are polished throughout.

Note: In the data table replace * with 4 if 304 grade is required, or with 6 if 316L grade is required.

Options:



(see key to symbols on pp 19–20)



Item code	Capacity (litres)	a	b	c	d	e	Skirt	Handle	Weight (kg)
CWL*001P	1	155	150	125	100	N/A	NO	SWING	0.4
CWL*002P	2	175	170	160	130	N/A	NO	SWING	0.7
CWL*003P	3	185	180	185	155	N/A	NO	SWING	1
CWL*004P	4	200	185	186	170	173	YES	SWING	1.3
CWL*005P	5	240	230	205	175	180	YES	SWING	1.4
CWL*006P	6	280	270	205	175	180	YES	SWING	1.7
CWL*008P	8	285	270	235	200	205	YES	SWING	2
CWL*010P	10	295	280	250	220	225	YES	SWING	2.5

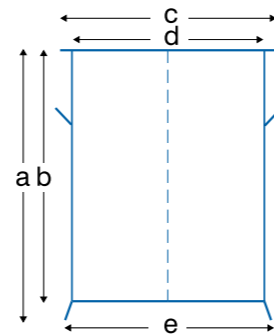

Churns

(A) Chemical churns



Manufactured from 316L grade stainless steel, these churns are specially designed for the storage and transportation of antibiotics and chemicals. They come complete with side carrying handles, skirtband and lid (secured by toggle clamps and a Viton® seal). They have crevice- and pit-free interiors and are polished throughout.



A Chemical churns
B Churns with swing handles
C Churns with side handles
D Churns with spout

Item code	Capacity (litres)	a	b	c	d	e	Skirt	Handle	Weight (kg)
CHU6015P	15	425	240	30	160	245	YES	SIDE	4.2
CHU6030P	30	530	300	30	200	300	YES	SIDE	7
CHU6040P	40	590	300	30	200	360	YES	SIDE	8
CHU6050P	50	700	400	30	200	360	YES	SIDE	9

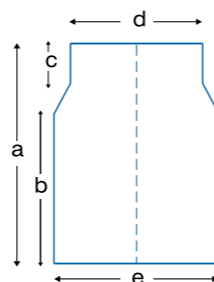

(B) Churns with swing handles



Item code	Capacity (litres)	a	b	c	d	e	Skirt	Handle	Weight (kg)
CHU4003P	3	215	150	40	120	155	NO	SWING	0.9
CHU4005P	5	265	190	40	140	175	NO	SWING	1.3
CHU4010P	10	330	250	40	160	225	YES	SWING	2.7
CHU4015P	15	370	280	50	200	275	YES	SWING	3.7
CHU4020P	20	420	330	50	200	275	YES	SWING	4.1

Manufactured from 304 grade stainless steel, these churns come complete with a swing handle, skirtband and lid. They have crevice- and pit-free interiors and are polished throughout.

(C) Churns with side handles



Item code	Capacity (litres)	a	b	c	d	e	Skirt	Handle	Weight (kg)
CHU4025P	25	420	290	55	205	320	YES	SIDE	5
CHU4030P	30	485	355	55	205	320	YES	SIDE	5.5
CHU4040P	40	550	385	80	220	355	YES	SIDE	7.8
CHU4050P	50	650	480	80	220	355	YES	SIDE	8.8

Manufactured from 304 grade stainless steel, these churns come complete with side carrying handles, skirtband and lid. They have crevice- and pit-free interiors and are polished throughout. On the 40 and 50 litre versions the lid is attached with a chain.

(D) Churns with spout



Item code	Capacity (litres)	a	b	c	d	e	Skirt	Handle	Weight (kg)
CHU4005S	5	265	190	40	140	175	YES	SWING	1.6
CHU4010S	10	330	250	40	160	225	YES	SWING	2.7
CHU4015S	15	370	280	40	200	275	YES	SWING	3.7
CHU4020S	20	420	330	50	200	275	YES	SWING	4.1

Manufactured from 304 grade stainless steel, these churns come complete with swing handle, bottom steadying handle, skirtband, pouring spout and lid. They have crevice- and pit-free interiors and are polished throughout.

Options (all churns):



(see key to symbols on pp 19–20)



Buckets and pails

(A) Buckets

Manufactured from 304 grade stainless steel with one size available in 316 stainless steel, these buckets are polished throughout, graduated in 1 litre intervals and come complete with swing handle. Skirtbands are standard as shown. Buckets without a skirtband are available to special order. Lids are available as an option.

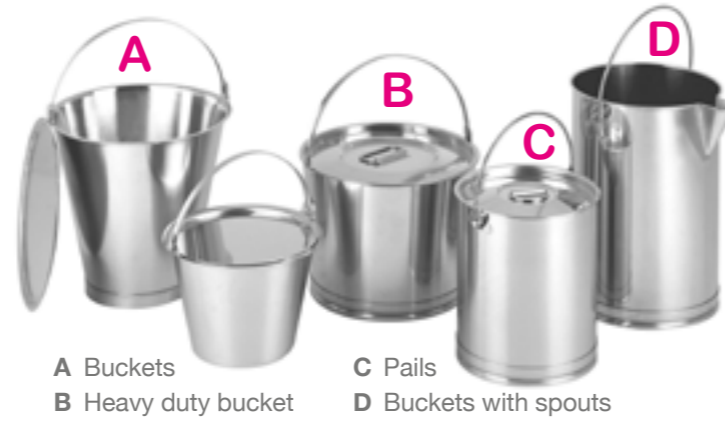

Item code	Capacity (litres)	a	b	c	Skirt	Handle	Grad.	Weight (Kg)	Lid Code	Lid Weight (kg)
BUC4007P	7	240	160	250	No	Swing	N/A	1	BUL4007P	0.4
BUC4008G	8	285	200	200	No	Swing	1-8/1	1.05	BUL4008P	0.55
BUC4010G	10	295	175	270	YES	SWING	1-10/1	1.4	BUL4010P	0.4
BUC4012G	12	320	210	260	YES	SWING	2-12/1	1.6	BUL4012P	0.5
BUC6012G	12	320	210	260	YES	SWING	2-12/1	1.6	BUL4012P	0.5
BUC4015G	15	325	202	340	YES	SWING	2-15/1	1.8	BUL4015P	0.6

(B) Heavy duty bucket

Manufactured from 304 grade stainless steel, this bucket is designed for heavy duty applications. It comes complete with a skirtband and swing handle and is graduated. Interiors are crevice- and pit-free and it is polished throughout.

Item code	Capacity (litres)	a	b	c	d	e	Skirt	Handle	Grad.	Weight (kg)
BHD4015G	15	255	240	340	320	295	YES	SWING	2-15/1	2.7

(C) Pails

Manufactured from either 304 or 316L grade stainless steel, these pails come complete with a skirtband and swing handle. They have crevice- and pit-free interiors and are polished throughout. Lids are available as an option.

Item code	Capacity (litres)	a	b	c	d	e	Skirt	Handle	Grad.	Weight (kg)	Lid code	Lid weight (kg)
PAI*010P	10	255	240	275	237	245	YES	SWING	N/A	2.1	PAL*010P	0.5
PAI*012P	12	283	273	275	237	245	YES	SWING	N/A	2.5	PAL*012P	0.5
PA*015P	15	285	275	305	267	275	YES	SWING	N/A	2.8	PAL*015P	0.6

(D) Buckets with spouts

Manufactured from 304 grade stainless steel, these straight sided buckets are graduated, come complete with pouring spout, swing handle, bottom steadying handle, and skirtband. They have crevice- and pit-free interiors and are polished throughout. Lids that are extended to cover the spout are available as an option.

Item code	Capacity (litres)	a	b	c	d	e	Skirt	Handle	Grad.	Weight (kg)	Lid code	Lid weight (kg)
BUS4010G	10	275	265	297	237	245	YES	SWING	1-10/0.5	2.3	BSL4010P	0.5
BUS4015G	15	308	295	320	267	272	YES	SWING	2-15/0.5	2.7	BSL4015P	0.6
BUS4020G	20	395	380	328	267	272	YES	SWING	2-20/1	3.4	BSL4020P	0.6

Note: In the data tables replace the * with 4 if 304 grade is required, or with 6 if 316L grade is required.

Options (all buckets and pails):



(key to symbols on pp 19-20)

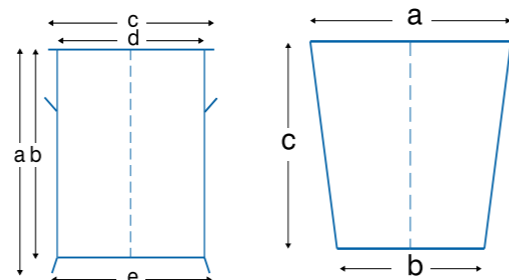

Containers and lids

Manufactured from 304 grade stainless steel, these containers are available with an optional stainless steel lid. They have crevice- and pit-free interiors and are polished throughout.



Item code	Capacity (ml)	Diameter (mm)	Depth (mm)	Weight (gm)	Lid code	Lid weight (gm)
COC4060P	150	60	60	140	COL4060P	30
COC4084P	250	85	50	175	COL4085P	60
COC4085P	400	85	85	200	COL4085P	60
COC4099P	300	100	50	200	COL4100P	75
COC4100P	700	100	100	225	COL4100P	75
COC4101P	1000	100	150	250	COL4100P	75
COC4120P	1200	120	120	535	COL4120P	90
COC4150P	2500	150	150	805	COL4150P	150
COC4200P	6000	200	200	1560	COL4200P	250

Options: E (see key to symbols on pp 19-20)

Bowls and basins

(A) Standard conical bowls

Manufactured from 304 grade stainless steel, these bowls are pressed in one piece with a flat base and flat rim for ease of carrying. They are crevice- and pit-free and polished throughout.

Item code	Capacity (litres)	a	b	c	Weight (gm)
BOW40.1P	0.1	70	40	50	25
BOW40.2P	0.2	100	60	50	50
BOW40.3P	0.3	105	65	60	60
BOW40.5P	0.5	130	75	70	95
BOW4.75P	0.75	165	95	75	135
BOW4001P	1	170	95	90	140
BOW41.5P	1.5	200	115	95	190
BOW4002P	2	220	110	120	240
BOW42.5P	2.5	235	145	100	320
BOW4003P	3	250	140	120	345
BOW4004P	4	270	150	130	425
BOW44.5P	4.5	285	175	120	460
BOW4005P	5	300	170	130	495
BOW4006P	6	320	190	145	575
BOW4008P	8	335	195	170	710
BOW4009P	9	340	195	180	710
BOW4011P	11	395	210	180	950
BOW4014P	14	410	210	195	1030

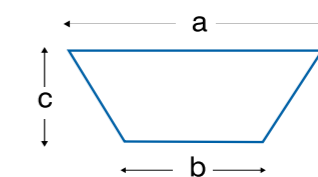

(B) Shallow conical bowl

Manufactured from 304 grade stainless steel, this bowl is made in one piece with a flat base and flat rim for ease of carrying. It is crevice- and pit-free and polished throughout.

Item code	Capacity (litres)	a	b	c	Weight (gm)
BOW4003L	3	275	200	75	400



(C) Lotion bowls

Manufactured from 304 grade stainless steel, these lotion bowls are supplied with a rolled top edge and flat base. They are crevice- and pit-free and polished throughout.

Item code	Capacity (litres)	a	b	c	Weight (gm)
LOB4120P	0.3	120	60	55	115
LOB4140P	0.5	140	70	65	155
LOB4180P	1	180	90	75	260
LOB4200P	1.5	200	100	80	290
LOB4220P	2	220	120	85	325
LOB4240P	3.5	240	95	110	400

(D) Wash basin

Manufactured from 304 grade stainless steel, this wash basin is supplied in one piece with a flat base and a rolled lip. It is crevice- and pit-free and polished throughout.

Item code	Capacity (litres)	a	b	c	Weight (gm)
WAB4360P	3	360	160	85	390

Trays

Shallow trays

Manufactured from 304 grade stainless steel, with several sizes available in 316L grade, these trays are supplied in one piece, with radiused corners. They are crevice- and pit-free, polished throughout, and have a rim approximately 10 mm wide.



Item code	Length (mm)	Width (mm)	Depth (mm)	Weight (gm)
TRA4157S	157	162	10	165
TRA4180S	180	120	10	177
TRA4215S	215	160	10	214
TRA4230S	230	162	10	240
TRA4300S	300	200	10	404
TRA4324S	325	317	10	665
TRA4325S	325	265	10	550
TRA4326S	325	143	10	300
TRA4327S	325	234	10	495
TRA4360S	360	240	10	629
TRA4385S	385	210	10	706
TRA4400S	400	270	10	706
TRA4440S	440	325	10	1015
TRA4451S	445	350	10	1059
TRA4900S	490	320	19	1161
TRA4495S	495	325	10	1000
TRA4500S	500	162	10	530
TRA4530S	530	325	10	1150
TRA6290S	290	210	10	425
TRA6320S	320	275	10	700
TRA6415S	415	240	10	690

Deep trays

Manufactured from 304 grade stainless steel, with several sizes available in 316L grade, these trays are supplied in one piece, with radiused corners. They are crevice- and pit-free and polished throughout.

Item code	Length (mm)	Width (mm)	Depth (mm)	Weight (gm)
TRA4220D	220	150	45	310
TRA4395D	395	280	70	1000
TRA4450D	445	350	25	1135
TRA4530D	530	325	100	2050
TRA4531D	530	325	150	2375

Note: part codes beginning 'TRA4' are supplied in 304 stainless steel, part codes beginning TRA6 are supplied in 316 stainless steel.



Water jacketed vessels

These stainless steel water jacketed vessels are available in 316L stainless steel, with a 304 stainless steel 0.1 bar low pressure water jacket. They are suitable for use with a non-pressurised water supply with hot or cold water for heating or cooling. These vessels are supplied with a 1/4" BSP water inlet at the bottom of the jacket and a 1/2" BSP outlet at the top. They have crevice- and pit-free interiors and are polished throughout.

Item code	Capacity (ltr)	a (mm)	b (mm)
VEJ6002P	2	130	170
VEJ6005P	5	175	230
VEJ6006P	6	175	270
VEJ6008P	8	200	270
VEJ6010P	10	220	270
VEJ6015P	15	267	275
VEJ6020G	20	265	390
VEJ6025G	25	300	390
VEJ6030G	30	300	445
VEJ6050G	50	350	535

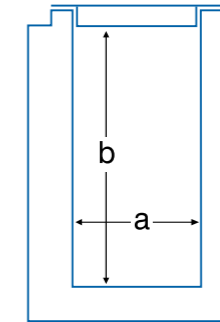

Trays

Shallow trays

Manufactured from 304 grade stainless steel, with several sizes available in 316L grade, these trays are supplied in one piece, with radiused corners. They are crevice- and pit-free, polished throughout, and have a rim approximately 10 mm wide.



Item code	Length (mm)	Width (mm)	Depth (mm)	Weight (gm)
TRA4157S	157	162	10	165
TRA4180S	180	120	10	177
TRA4215S	215	160	10	214
TRA4230S	230	162	10	240
TRA4300S	300	200	10	404
TRA4324S	325	317	10	665
TRA4325S	325	265	10	550
TRA4326S	325	143	10	300
TRA4327S	325	234	10	495
TRA4360S	360	240	10	629
TRA4385S	385	210	10	706
TRA4400S	400	270	10	706
TRA4440S	440	325	10	1015
TRA4451S	445	350	10	1059
TRA4900S	490	320	19	1161
TRA4495S	495	325	10	1000
TRA4500S	500	162	10	530
TRA4530S	530	325	10	1150
TRA6290S	290	210	10	425
TRA6320S	320	275	10	700
TRA6415S	415	240	10	690

Deep trays

Manufactured from 304 grade stainless steel, with several sizes available in 316L grade, these trays are supplied in one piece, with radiused corners. They are crevice- and pit-free and polished throughout.

Item code	Length (mm)	Width (mm)	Depth (mm)	Weight (gm)
TRA4220D	220	150	45	310
TRA4395D	395	280	70	1000
TRA4450D	445	350	25	1135
TRA4530D	530	325	100	2050
TRA4531D	530	325	150	2375

Note: part codes beginning 'TRA4' are supplied in 304 stainless steel, part codes beginning TRA6 are supplied in 316 stainless steel.



Pressure vessels

Pharma Hygiene Products manufacture pressure vessels suitable for lab scale/small batch production environments.

The types of pressure vessel we offer are:

- Vessel with internal pressure
- Vessel with internal vacuum pressure
- Pressurised heating or cooling jacket, with liquid in the jacket, with no pressure in the vessel
- Pressurised vessel with pressurised liquid heating jacket

Please note that to fall within the necessary Sound Engineering Practice specifications, Volume multiplied by Pressure must be equal to or less than 50.

Polypropylene vessels

Pharma Hygiene Products can supply a range of mobile polypropylene vessels for products that cannot come into contact with stainless steel.

These vessels have welded seams and are supplied with drop on lids. An external stainless steel band can be added with two carrying handles to aid moving when empty. A mobile frame set on four castors (two braked) is an optional extra.

Propeller or high shear mixers can also be supplied, and the vessels are available in various sizes.

Please enquire for further information.





Mobile mixers

Manufactured from 304 grade stainless steel, with 316L grade contact parts, these mixers are designed for use with any open vessel of suitable dimensions.

Available with either a high-shear mixing head for mixing emulsions, or a propeller mixing head for mixing free dissolving powders and for general mixing.

The mixing head is mounted on a mobile stand with painted hydraulic cylinder (manually operated), and the control panel is IP55 rated and constructed from stainless steel. Mixers can be specified with 3-phase or single phase power options.

Safety interlocks and a motor shroud are further options.

Item code	Model	Operating rpm
CSP-HM	Mobile high-shear mixer	2900
CSP-PM	Mobile propeller mixer	1400



High shear mixer



Propeller mixer

Integrated mixers and agitators

Pharma Hygiene Products can supply a wide variety of mixers and agitators, and mount them on our standard and custom vessels and containers to meet your specific requirements.

We offer high-shear mixers for mixing emulsions, propeller mixers for free dissolving powders, as well as general mixing, and slow agitators for keeping products suspended. All can be supplied in varying power and speed specifications.

Please enquire for further information.



Customised process equipment

Pharma Hygiene Products can meet your needs precisely. In addition to our extensive range of standard process equipment we can supply more sophisticated process equipment, engineered to meet your exact requirements, including:

- Jacketed vessels
- Mixing vessels
- Complete processing systems
- Pressure vessels

Adapting one of our standard products often provides a cost-effective solution, but we can also design and build vessels and other equipment to your specification. Please let us know if you have a project you wish to discuss and we will arrange a discussion with one of our engineers.

